



Flip Extension Install Instructions

Tools Required: Tape Measure, knife, Allen key set, Phillips screwdriver, a 1/2" wrench, and a 1/2" socket

1.0 Preparing TRUCKBOSS Deck.

- 1.1 Remove the plastic end caps from the rear of the TRUCKBOSS deck. This is done by using a Phillips screwdriver to remove two screws. The first one is underneath the end cap and the second can be accessed from the rear of the cap.



- 1.2 Using a 1/2" socket, remove any D-Rings located in the rear two modules of the TRUCKBOSS deck surface and/or in the back half of the TRUCKBOSS sides.



- 1.3 Open the TRUCKBOSS sides.

2.0 Flip Extension

- 2.1 Remove the hardware bag. Contents: two bobtail caps, eight serrated flange nuts, eight 3/4" carriage bolts, and six knobs for operating this extension. (The sixth knob can be found holding the two side arms together. Remove and place



with the hardware)



Flip Extension Install Instructions

2.2 Unpack the sides by cutting off the plastic strap.

2.3 **Remove the bobtail end cap.** -- Keep an even pressure on the actual bobtail end to keep it level. Use a 3/16 Allen key head on the two bolts. The reason for keeping it level is that the bolt can catch onto that bobtail end cap and bind. Reinstall the bobtail with the bobtail cap that is supplied with the flip extension. The new bobtail cap is cut off as the flip extension will rest on it when it's fully extended. Repeat on both sides.



2.4 **Add hardware onto the TRUCKBOSS deck.** -- On each side, four 5/16 by 3/4" bolts will be added to the surface of the deck and two knobs with 1" carriage bolts will be added to the deck sides. The two 3/4" carriage bolts should be added into each of the two rear capture channels on each side. The knobs should be added into the lower of the two capture channels on the each of the sides.



2.5 Lift the main extension out of the box. Remove the wood shipping blocks off of both sides

2.6 Remove the surface brackets from each side of the main extension assembly. Keep hardware for later use in the install.

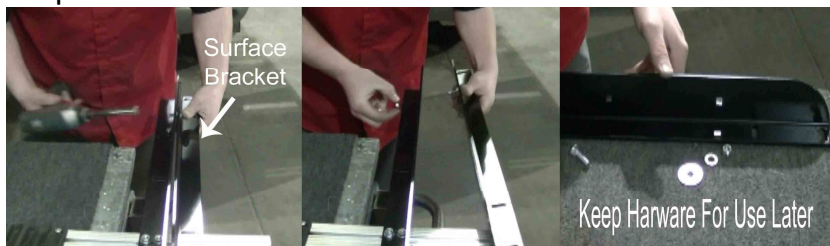



Flip Extension Install Instructions

2.7 Install the surface bracket. To install the surface bracket, ensure that the L-shape is facing the outside of the deck. Align the surface bracket on the deck using a 4-1/4 inch spacing from the outside of the L-shaped surface bracket to the edge of the deck surface. Hand tighten four serrated flange nuts on to the bolts. (Hand tightening at this stage will allow more flexibility when mounting the rest of the actual flip extension). Repeat this process on both sides.



2.8 Install the pull-out sides in to the main extension assembly. Slide the sides into each side of the main assembly.



2.9 Install the main extension assembly.

2.9.1 Lift the deck extension onto the surface of the TRUCKBOSS deck with the bottom facing up and the arms facing the rear of the truck.





Flip Extension Install Instructions

- 2.9.2 Line up the edge of the deck extension surface such that it is in line with the edge of the surface of the TRUCKBOSS itself. Ensure that the angle bracket on the extension is on the inside of the surface bracket on both sides.



- 2.9.3 Line up the first hole on the deck extension bracket with the third hole on the inside of the surface bracket.

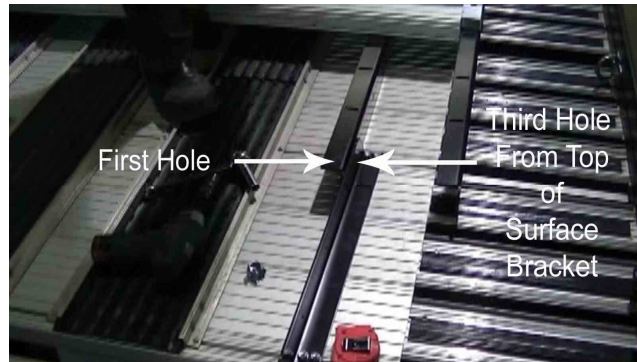



Flip Extension Install Instructions

- 2.9.4 Using the hardware saved from step 2.6 the extension will be attached to the surface bracket. Insert the 1" bolt into the surface bracket, place the fender washer in between the surface bracket and the extension bracket, then on the opposite side use the 5/16 flat washer and the nylon lock nut. Hand tighten only. Perform this step on both sides.



- 2.9.5 Confirm that the surface bracket is 4.25" from the edge of the TRUCKBOSS deck. Tighten down the surface bracket. Once the surface bracket is tightened tighten the pivot. Do not overtighten the pivot, tighten until it's got tension and then back it off a half turn.



- 2.10 Reattach the end caps on the TRUCKBOSS deck.

- 2.11 **Flip the extension down.** -- Grab it from the middle. Make sure to bend knees. Then pivot it down.





Flip Extension Install Instructions

2.12 Locking down the extension in its out position. -- Using a knob from the parts bag attach it to the surface bracket and extension as shown below. To lock out the outside remove the knobs, line up the two bolts with the two furthest holes located on the extension side. Be sure to try and keep the inside plank as square to the inside of the main plank. Attach knobs. Repeat this process for the other side and you'll have a locked-out deck extension.



2.13 With the deck extension now locked in the out position the sides can be shut. The angle bracket on the extension will prevent the side from going all the way in. This is normal and the way that it was designed.





Flip Extension Install Instructions

2.14 Flipping up the extension.

2.14.1 First step is to expand your sides on the TRUCKBOSS deck.

2.14.2 Next remove the six knobs that are located on the extension. (Also remove the 2 bolts associated with the knobs in the centre of the deck) Keep the hardware in a safe place as it will be used when securing for transport.



2.14.3 This allows the side arm to be moved inwards. Repeat the process on the other side.





Flip Extension Install Instructions

2.14.4 Once all the knobs have been removed, grab the center of the ramp bar, pull up, and place the extension gently on the deck surface.



2.14.5 Slide out the extension side. Line up a single bolt (in TRUCKBOSS side) with the middle hole in the extension side. Secure with knob. Secure spare bolt on TRUCKBOSS side with a knob. The spare bolt and knob can be attached to the surface bracket. Repeat that process for the other side. Close the TRUCKBOSS sides. Ready for transport.



2.15 We hope you enjoy your deck extension on your TRUCKBOSS Deck System and hope you get a lot of good days out there riding.